

### General & Safety Information

- Wear proper personal protective equipment (PPE).
- Operate all tools per manufacturer guidelines.
- Standard woodworking saws and blades can be used for cutting Fypon® polyurethane (PUR) products.
- Fypon PUR parts are NOT load bearing.
- For remodeling applications and alternative façades like stucco, vinyl, etc., please refer to Fypon General Remodeling and Alternative Façade Instructions, which can be found at [fypon.com/install](http://fypon.com/install).
- For best results, finish and allow to dry prior to installation. Refer to Fypon General Finishing Instructions, which can be found at [fypon.com/install](http://fypon.com/install).
- All Fypon products must be installed per the following instructions and finished within 90 days of installation to maintain warranty coverage.

### Tools / Materials

- Pencil
- Tape Measure
- Level
- Square
- Hammer or pneumatic nailer
- Nail countersink
- Drill / driver (if using screws)
- Putty knife
- Saw (if trimming)
- Sandpaper (220-grit recommended)
- Caulk gun
- Exterior-grade polyurethane-compatible sealant and / or filler
- Exterior-grade polyurethane-compatible adhesive (Loctite® PL Premium® recommended)
- Exterior-grade fasteners (trim head screws recommended)

### Installation Instructions

#### 1) Cut moulding to length.

Allow moulding to acclimate to the installation temperature for 24 hours before cutting it to length.

Measure location where moulding will be installed. Add 1/4" for every 10 feet of length and cut the moulding to that length to prevent gaps due to contraction in cold temperatures.

Note: Cut for miter joints at corners and butt joints at other seams.

#### 2) Install ledger strip (if needed).

If the molding is hollow, install a ledger strip for it to mount to (Figure 2).

Figure 2

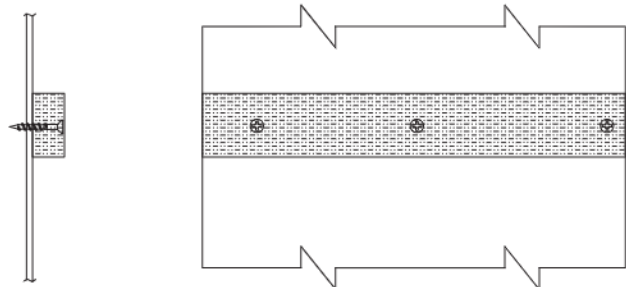

### 3) Apply adhesive.

Apply a 1/4" bead of adhesive on the mounting surface of the moulding, leaving some gaps at the bottom for water to escape (Figure 3A).

**IMPORTANT!** Also apply adhesive liberally on the ends at all seams to prevent separation (Figure 3B).

Figure 3A

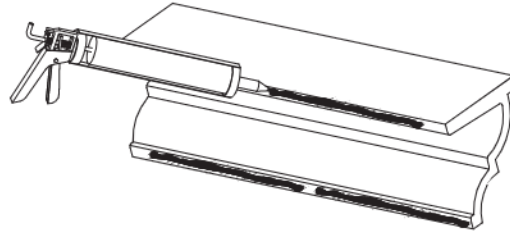
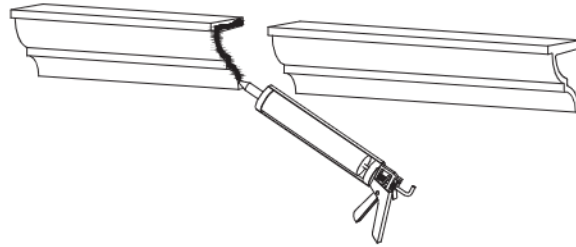

Figure 3B



### 4) Fasten moulding.

Use exterior-grade fasteners spaced not more than 16" apart, and not less than 3" from the end of each piece to secure moulding to the wall or ledger strip (Figure 4A). If the piece is between other pieces of moulding, it should spring fit (Figure 4B). Remove excess adhesive before it dries.

Figure 4A

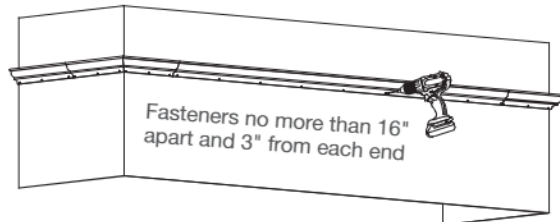

### 5) Fill and sand fastener holes.

Fill fastener holes with filler and sand to match surrounding area, if needed, but be careful not to remove the primer.

Figure 4B

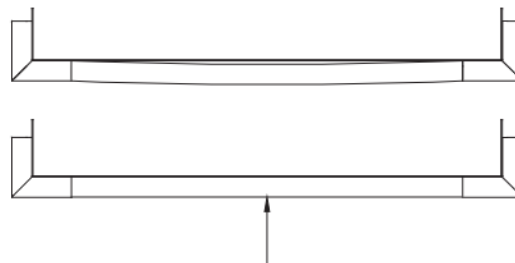

### 6) Touch up or finish.

Refer to Fypon® General Finishing Instructions. If part was finished prior to installation, touch up filled fastener holes with color-matched finish. Caulk edges and exposed fastener heads to prevent water penetration around the moulding.